

NOTE:

1. ALL DIMENSIONS ARE REFERENCE ONLY.
2. DIMENSIONS IN PARENTHESES ARE METRIC.
3. THE ** DENOTE COLOR.
4. DUCT AND COVER ARE AVAILABLE IN 6 FT (1828.6) LENGTH.
5. PANDUIT DRDSF PLASTIC SCREW FASTENERS INCLUDED TO FASTEN USER SUPPLIED DIN RAIL TO DRD BASE.
6. LOCATING RIBS COMPATIBLE WITH 15 OR 35 mm DIN RAIL.

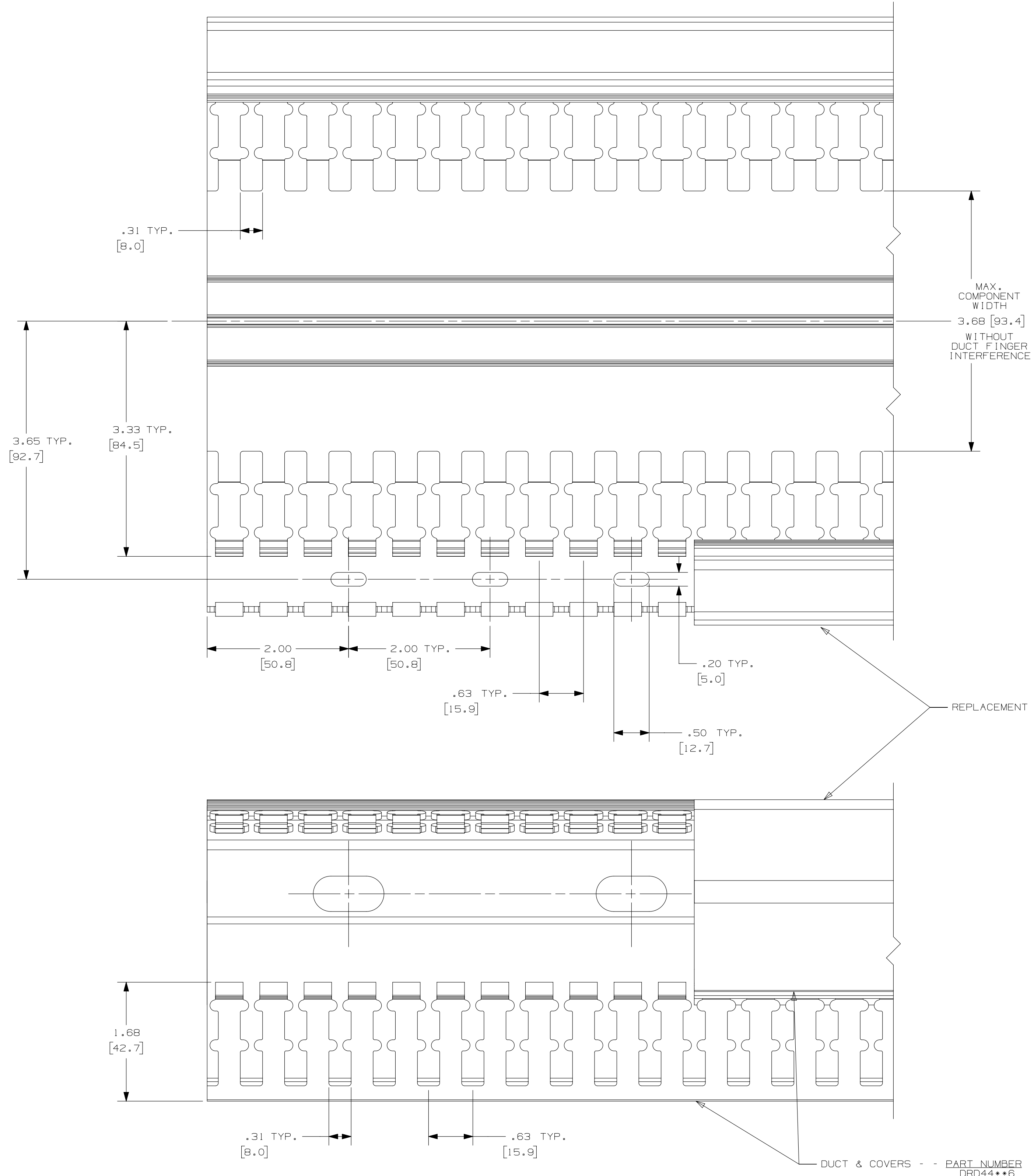
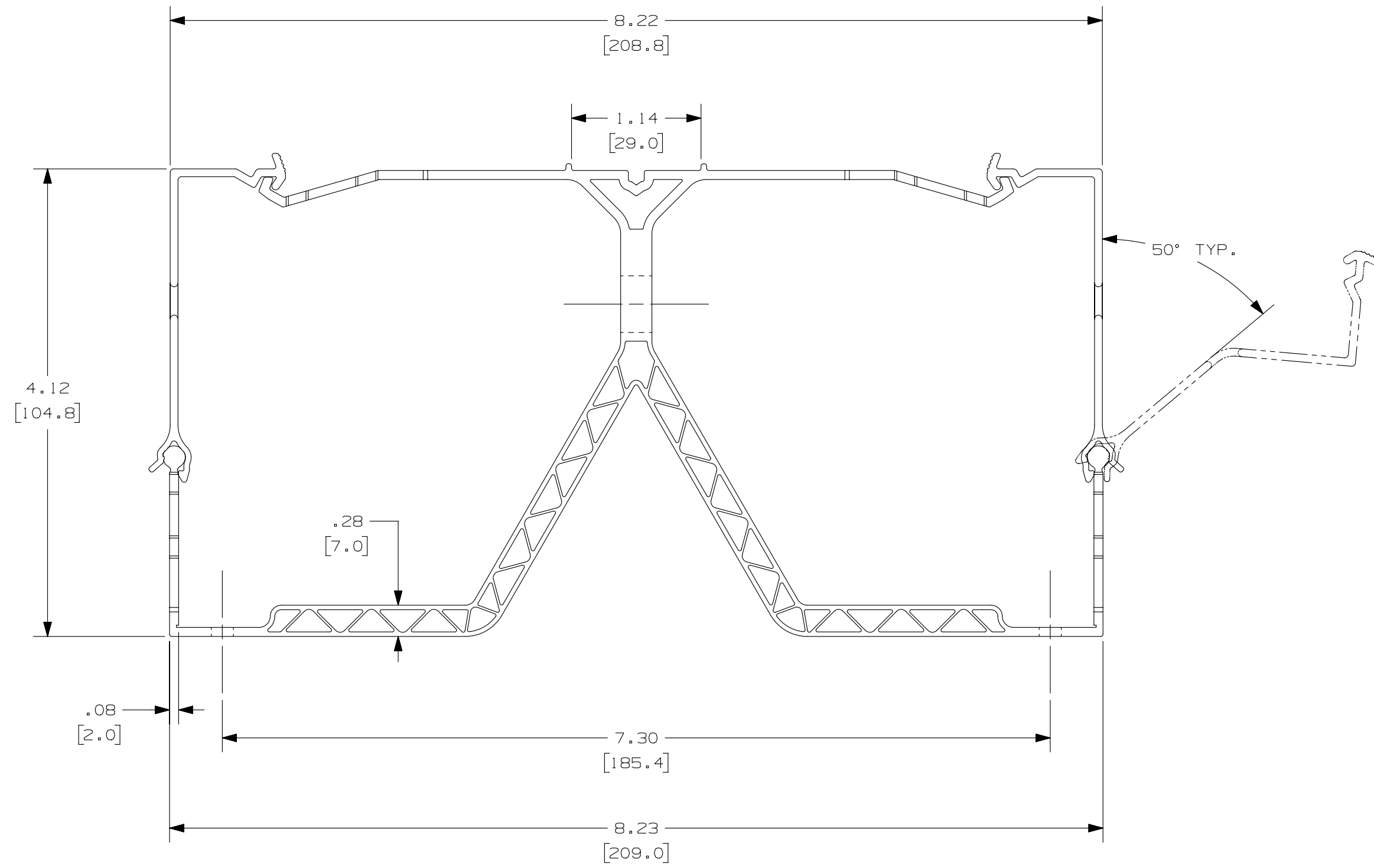

MAX. COMPONENT WIDTH
3.68 [93.4]
WITHOUT DUCT FINGER INTERFERENCE

REPLACEMENT COVERS - - PART NUMBER DRDC4**6

DUCT & COVERS - - PART NUMBER DRD44**6

REV	DATE	BY	CHK	APR	DESCRIPTION	ECN
5	08.03.14	BDK	MRJS	JADE	J. DRAWING REVISION 4 ITEM G SHOULD STATE "UPDATED PROFILE TO NEW DESIGN"	36897-1251

TITLE WIRING DUCT - TYPE DRD44 DIN RAIL DUCT WITH COVER		MARKETING DRAWING	
ITEM REVISION NAME D11000VL/03	DATASET FILE NAME D11000VL_DC/038		
UNLESS OTHERWISE SPECIFIED, DIMENSIONAL TOLERANCES ARE: (IN 1 mm)			
XX ±	XXX ±	XX ±	ANGLES ±
DRAWN BY / DATE JCST / 06-16-08		CHK / SCALE MKBE / FULL	
DRAWING NUMBER 36897-1251		SHEET NUMBER SHT 1 OF 1	